

VERIFIED 3-29-03

AB-10-S X SPEC

.66R PLUS 5° DRAFT PER SIDE
4 PLS. EQ. SPACED DN 14.00 THRU 15.00 DIA. B.C.

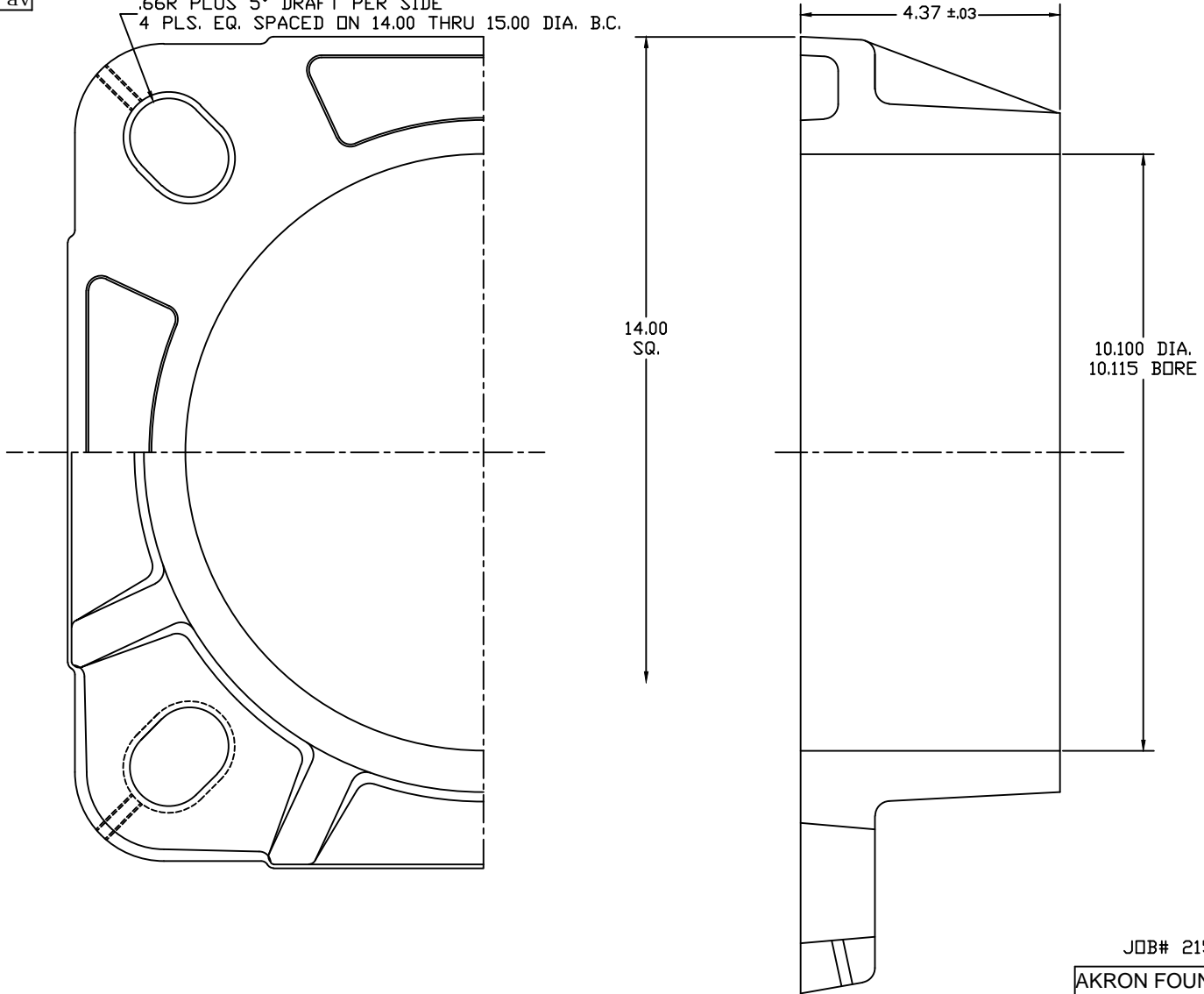

JOB# 2159-S X SPEC

AKRON FOUNDRY COMPANY	
10" CAST ANCHOR BASE	
STRAIGHT CORE	
2-22-99	356 T6
FULL	L YERGIN

AB-10-S X SPEC

PAGE 23C

RECOMMENDED BOLT - 1/4-20 N.C. X 5/8 LG. STAINLESS STEEL PLAIN HEX WASHER HEAD TYPE